

Building Plot 2 approved under
Planning Application Refs
11/00750/PPP & 14/01220/AMC

Building Plot 1 approved under
Planning Application Refs
11/00750/PPP & 14/01314/AMC

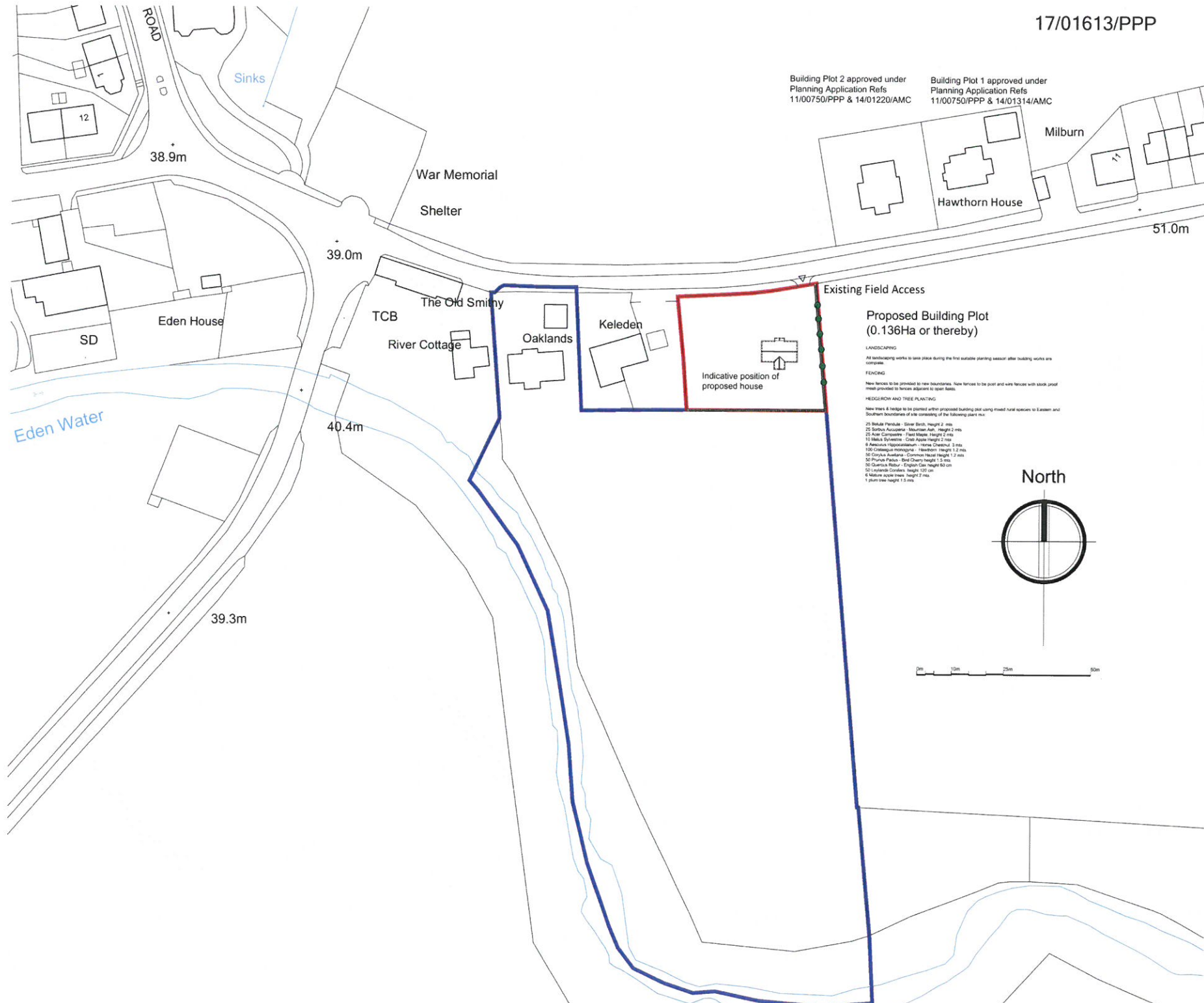

Existing Field Access

**Proposed Building Plot
(0.136Ha or thereby)**

LANDSCAPING
All landscaping works to take place during the first suitable planting season after building works are complete.

FENCING
New fences to be provided to new boundaries. New fences to be post and wire fences with stock proof mesh provided to fences adjacent to open fields.

HEDGEROW AND TREE PLANTING
New trees & hedge to be planted within proposed building plot using mixed rural species to Eastern and Southern boundaries of site consisting of the following plant mix:

- 25 Salix Purpurea - Silver Birch Height 2 mts
- 25 Sorbus Aucuparia - Mountain Ash Height 2 mts
- 20 Ash Compensate - Field Maple Height 2 mts
- 10 Malus Sylvestris - Crab Apple Height 2 mts
- 8 Prunus Spondiops - Horned Cherry 3 mts
- 100 Crataegus monogyna - Hawthorn Height 1.2 mts
- 100 Crataegus Aucuparia - Common Hazel Height 1.2 mts
- 50 Prunus Padus - Bird Cherry height 1.5 mts
- 50 Quercus Robur - English Oak Height 60 cm
- 50 Leylandii Complanata height 100 cm
- 6 Mahoe acuta new height 2 mts
- 1 plum tree height 1.5 mts

Indicative position of proposed house

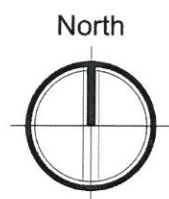

Scottish Borders Council
Town And Country
Planning (Scotland) Act
1997

REFUSED

subject to the
requirements of the
associated Decision
Notice

Reproduced from the Ordnance Survey
1:2500 scale map with the permission of
the controller of Her Majesty's Stationery
Office.
CROWN COPYRIGHT RESERVED.
Licence No. ES 731987

Revision	Description	By	Chk
project			

Proposed Building Plot
Land East of Keledon
Ednam

Site
Location Plan

scale	size	date	drawn	checked
1:500	A1	Nov 2017	PG	

ATKEN TURNBULL ARCHITECTS
9 Bridge Place
Glasgow
TD1 1SN
01896 752760
enquiries@atken-turnbull.co.uk
www.atken-turnbull.co.uk
Also at Dumfries & Edinburgh



project no.	drawing no.
AT3007	PP-01